







SOUTH LINCOLN REDEVELOPMENT FINAL MASTER PLAN

August 11, 2009

KEY

-  DHA Property
-  City Property
-  Townhouses
-  Flats
-  Non-Residential uses
(may have flats above)
-  Existing trees to be preserved

PLAN DESCRIPTION (ENGLISH)

The concept is focused around 10th Avenue, where the non-residential uses will make it an active street. It creates a promenade for a direct view to the light rail station, with art and sculpture to help with wayfinding. A public plaza provides flexible space for neighbors and visitors to gather, and could be closed to traffic for special occasions or festivals.

Family-friendly townhomes and lower buildings along Mariposa Street provide a transition to the historic neighborhood to the east. Open spaces have been designed to be publicly visible. Homes face the open spaces promoting passive surveillance and security. The design also promotes safety by lining streets and sidewalks with front doors and stoops allowing for added 'eyes on the street'. The emphasis is on 'green streets' with new tree plantings and comfortable sidewalk widths to encourage walking, making it easier to meet neighbors and provide better access to community amenities. Designated bike routes are delineated providing access the Cherry Creek trail and the Platte River trails.

Please follow redevelopment progress on the Project Website:

www.denverhousing.org/DHA/Development/South+Lincoln/

or contact the Denver Housing Authority

Lynne Picard, email: lpicar@denverhousing.org, phone 720-932-3052

Kimball Crangle, email: kcrang@denverhousing.org, phone 720-932-3123

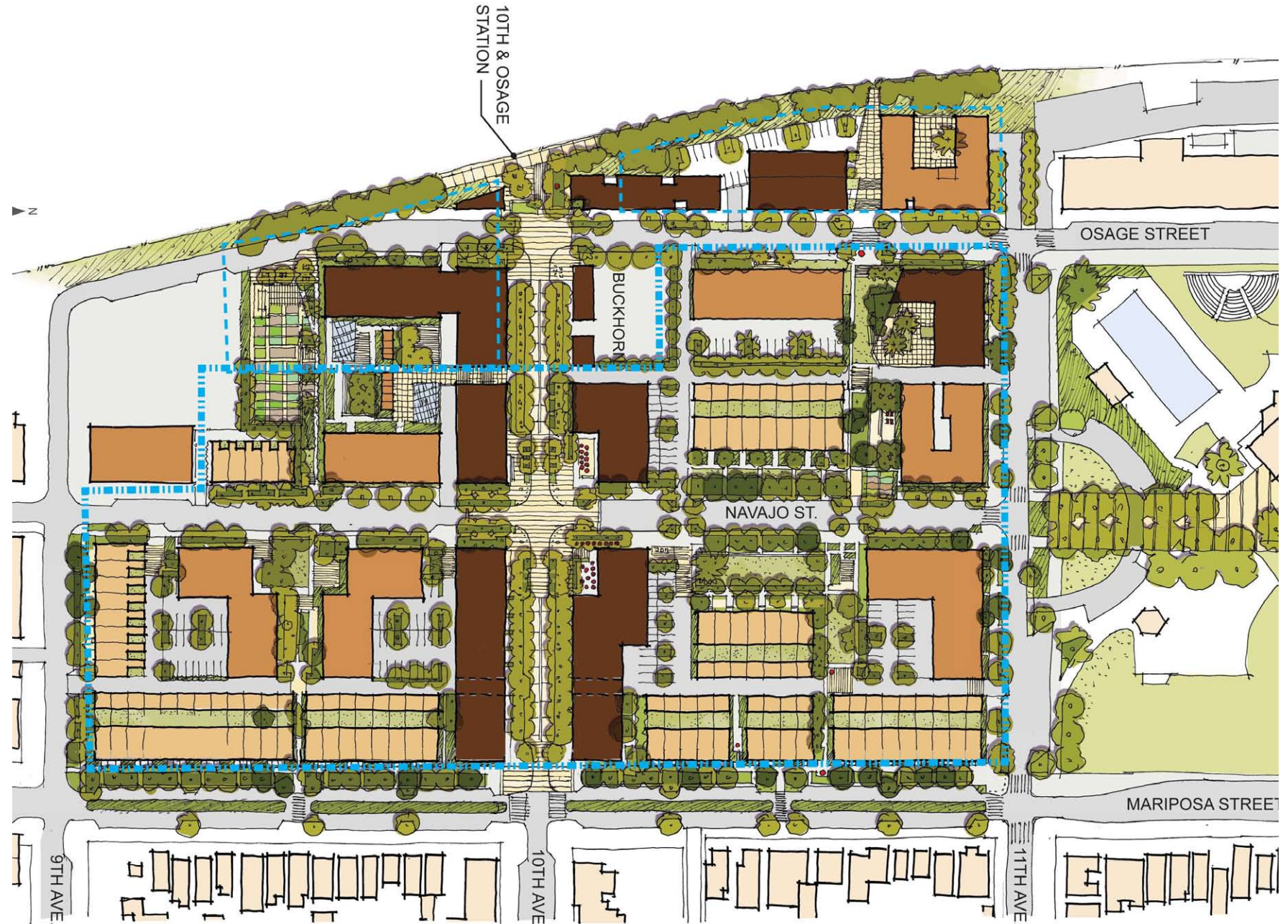

MITHUN



EnviroHealth Consulting



SOUTH LINCOLN REDEVELOPMENT MASTERPLAN

11 August 2009 Final Redevelopment Masterplan Celebration

© Mithun 2009
Pier 66 1201 Alaskan Way Seattle WA 98101
206.623.3344 mithun.com